



Flint Hills Mall

1632 Industrial Road - Emporia



Retail SPACE **FOR LEASE** Emporia, KS

Regional Mall located in the center of Emporia's exciting and growing commercial district. Anchor merchants include Sutherlands & Dunham's Sports Additional merchants include Harbor Freight, B&B Theater, Bath & Body Works, Bling, Buckle, Claire's, Hibbett Sports, NexTech Wireless, Maurices, Petsense, Shoe Sensation.

Space Available:

Space 1-2006 **6,700 SF.**

All information furnished regarding property for sales, rent, exchange, or financing is from sources deemed reliable, but no guarantee is made, or responsibility assumed as to its accuracy or completeness and you are advised to make your own analysis and verification. Broker hereby notifies prospective buyer/lessee that (a) Broker will be acting as an agent of seller/lessor with the duty to represent seller/lessor's interest; (b) Broker will not be the agent of buyer/lessee; and (c) Information given to Broker will be disclosed to seller/lessor.

Details:

- Building Size: 250,000 SF
- Zoning: Commercial
- Lease Rate: Negotiable



Clarence Frye

620.342.4631

cfrye@weigandomega.com



David Lewis

316.263.2215

dlewis@weigandomega.com



Weigand-Omega Management, Inc.
333 S. Broadway Ave
Wichita, KS 67202-4325

WeigandOmega.com



Flinthills Mall - Suite 1-2006

1632 Industrial Road, Emporia, KS 66801

AERIAL VIEW



INTERIOR/EXTERIOR

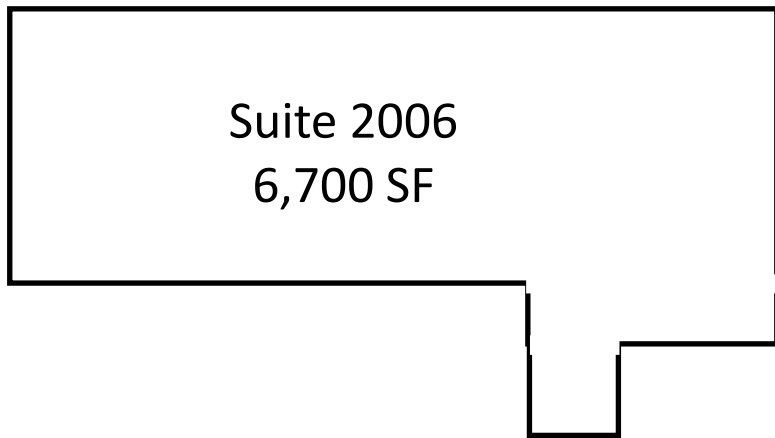

Suite 2006
6,700 SF



Clarence Frye
620.342.4631
cfrye@weigandomega.com



David Lewis
316.263.2215
dlewis@weigandomega.com



Weigand-Omega Management, Inc.
333 S. Broadway Ave
Wichita, KS 67202-4325

WeigandOmega.com



Flinthills Mall - Suite 1-2006

1632 Industrial Road, Emporia, KS 66801

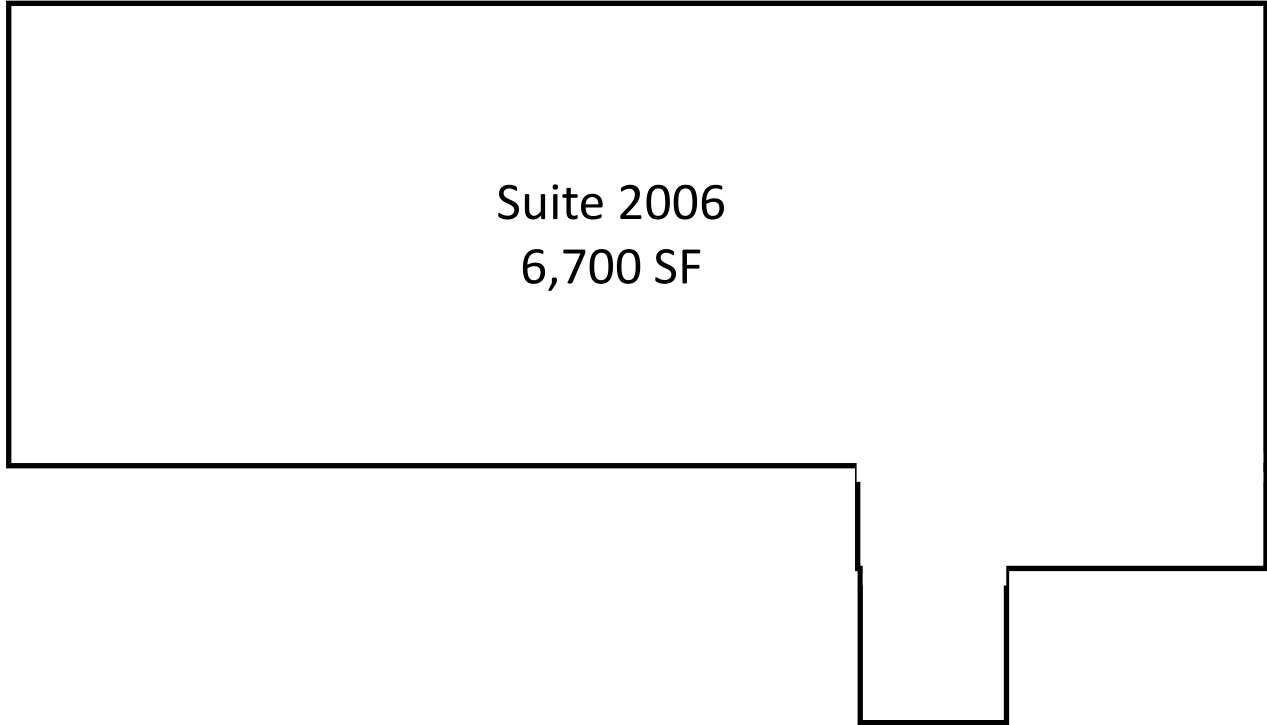

Suite 2006
6,700 SF

44' West Frontage on Industrial Road



Clarence Frye

620.342.4631

cfrye@weigandomega.com



David Lewis

316.263.2215

dlewis@weigandomega.com



Weigand-Omega Management, Inc.
333 S. Broadway Ave
Wichita, KS 67202-4325

WeigandOmega.com



Flinthills Mall - Emporia, KS

1632 Industrial Road, Emporia, KS 66801

Scooter's Coffee
2,000 SF

Legend

- 107. Claire's – 749 SF
- 129. Kansas Driver's License – 1,008 SF
- 130. Focus Workforce – 1,515 SF
- 134. Vacant – 640 SF
- 135. US Marine Corps Recruiting – 677 SF
- 138. Crystal Nails – 1,932 SF
- A. Maintenance Office – 788 SF
- B. Mall Offices (2) – 422 SF
- C. Restrooms – 542 SF

 = Mall Entry

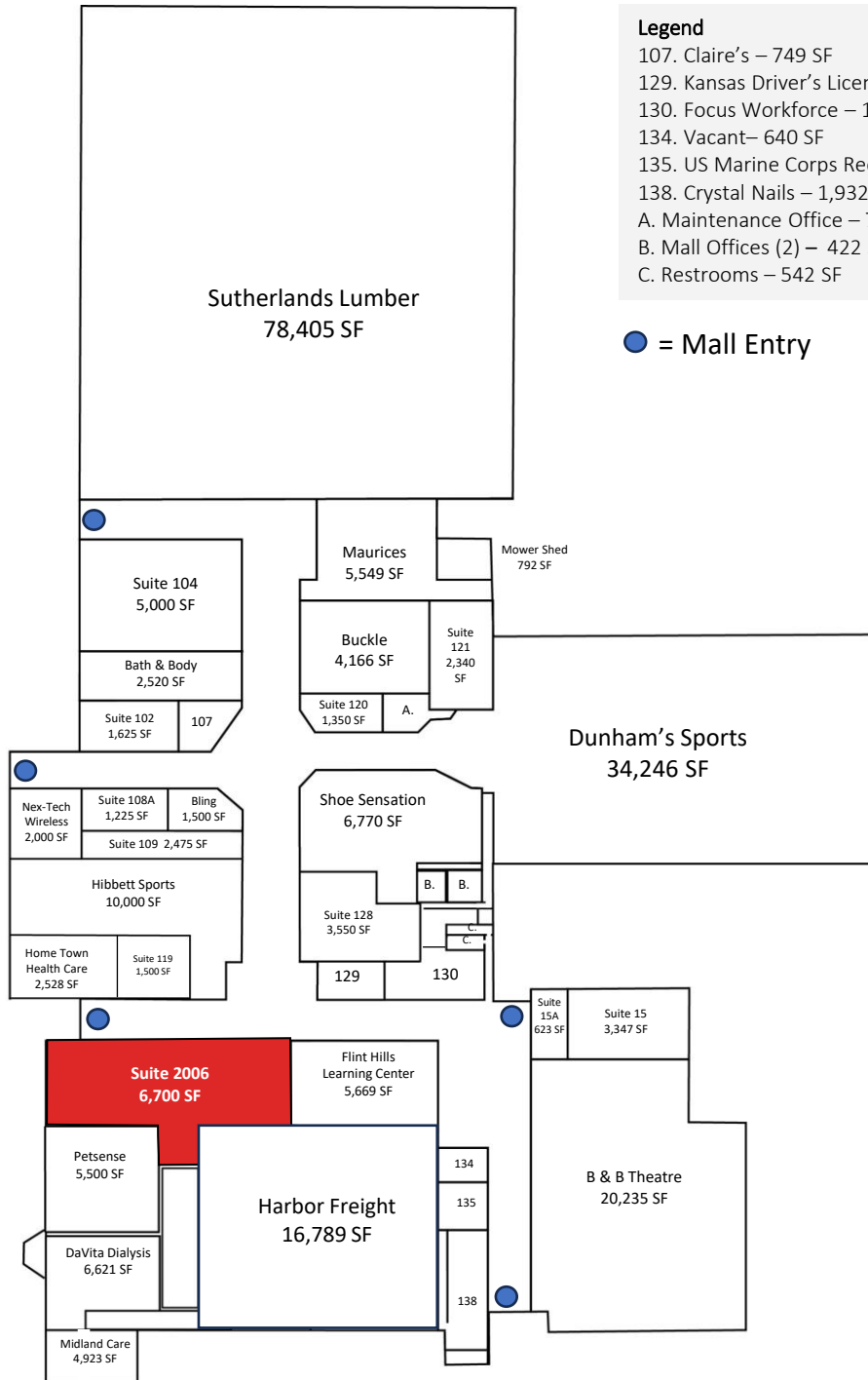

WeigandOmega.com



Weigand-Omega Management, Inc.
333 S. Broadway Ave
Wichita, KS 67202-4325



David Lewis
316.263.2215

dlewis@weigandomega.com